

PIR Sensor



Technical Features:

Dimensions: \varnothing 48mm X 12mm

Operating Temperature: -20°C to 40°C - Indoors

Warranty: 3 years with proper installation

Installation: Use 2 M3.0x10 screws

Input/Output voltage : DC12V or DC24V

Related load wattage: Max 24W in 12V or 36W in 24V

Detection Distance: 3m

Detection Range: 120°

Delay time: It can be adjusted from 10s to 10 minutes

Functional information:

1. Automatic detection: when people enter the active zone, infrared ray detector will output 12V or 24V and the light turns on.
2. Delay function: when people leave the active zone or people stay still, the light will turn off after the delay time you choose. And the delay time can be adjusted from 10s to 10mins.
3. Continuous detection: when people have activities during the period of delay time, the detector works and the light is always on.

Safety Information:

PIR SENSOR is especially designed for LED light system, use for other product maybe can't work normally

Drawing:

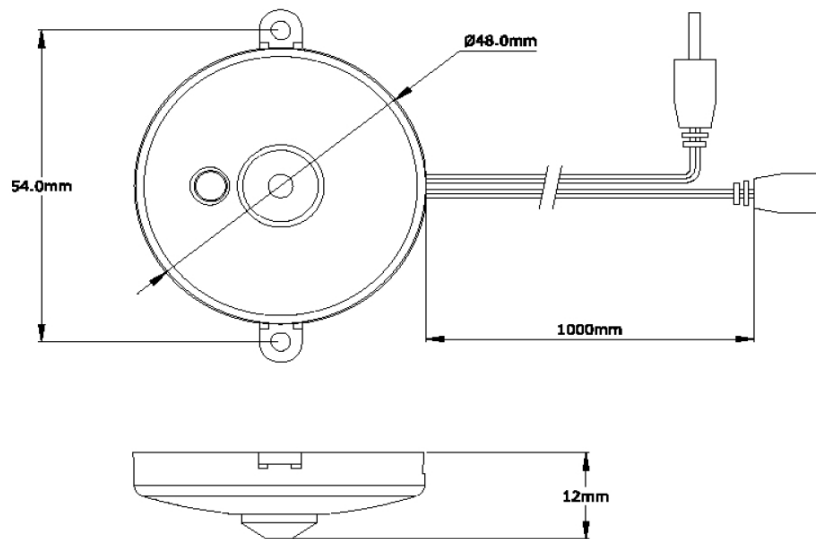

Installation information:

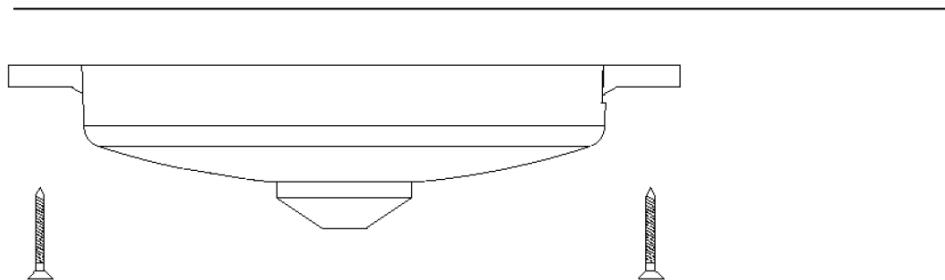

2 M3.0x10 screws make it easy to install

PIR sensor installation location:

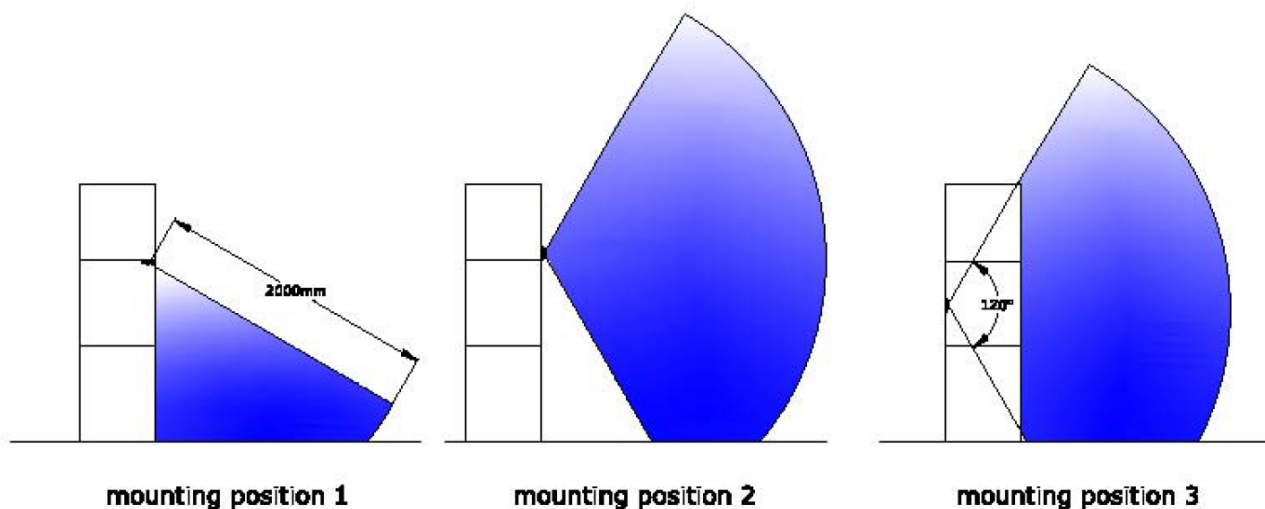

Note: this picture shows that the pir sensor can be installed in different locations, and then the effective zone is different. You may choose correct mounting location according to your purpose.

Complete set connection guide

