

Ministure 2-Channel Shortwave Receiver Multicoupler

DESCRIPTION

- Active wideband receiver multicoupler for the LF, MF, HF and low VHF bands.
- For use where two receivers have to share the same antenna.
- Wide frequency range: Covers 10 kHz – 108 MHz.
- High isolation between the two receiver outputs.
- Amplifier built in to compensate for loss in multicoupler network.
- Adjustable gain.
- High IP2 and IP3.
- Low amplifier noise figure.
- Wide supply voltage range.
- N-, BNC- or TNC-female connectors on all ports.

SPECIFICATIONS

Electrical	
Model	PRO-MAR2-N
Gain (Input To All Outputs)	Adjustable from < -8 dB to > +2 dB
Frequency	10 kHz - 108 MHz
Gain Variance	Better than +/-1 dB
Noise Figure	< 5.5 dB @ 10 MHz, < 4.5 dB @ 108 MHz
OIP3	> +17 dBm (@ gain = max.)
P1dB	> +6 dBm (@ gain = max.)
OIP2	> +29 dBm (@ gain = max.)
Isolation Between Outputs	Min. 17 dB, typ. > 20 dB
Input VSWR	< 2.0:1
Input-Output Isolation	> 25 dB
Output VSWR	< 1.5:1
No. Of Channels	2

Mechanical	
Power Supply	11 to 25 V 90 mA
Input Connection(s)	N-, BNC- or TNC-female
Dimensions	138 (incl. conn.) x 152 (incl. flanges) x 35 mm / 5.43 x 5.98 x 1.38"
Weight	0.4 kg / 0.88 lb
Mounting	4 mm dia. (4 holes)

ORDERING

Type	Product No.
PRO-MAR2-N	210001583
PRO-MAR2-BNC	210001584
PRO-MAR2-TNC	210001585



DIAGRAM

MOUNTING DETAILS

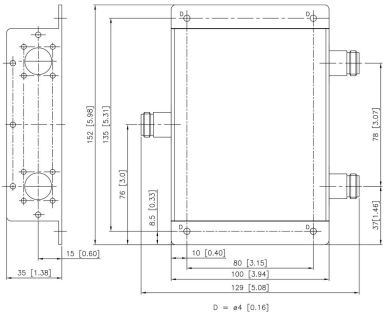

All dimesnsions are given in mm [in.]

