

Unity Gain ¼ λ Mobile Antenna for the 450 MHz Band

DESCRIPTION

- Sturdy, conical, flexible rubber whip.
- MU 5-ZG/s covers 370–410 MHz
 - MU 5-ZG/l covers 406–440 MHz
 - MU 5-ZG/h covers 430–470 MHz
 - no tuning required.
- Stainless steel ZG-mount with M8-thread whip-fastening system.
- Simple mounting exclusively with access from the outside.
- Choice between two connection principles:
 - ZG-mount: FME-connection (supplied without cable)
 - ZGP4-mount: Permanently attached 4 m cable terminated with FME-connector.



ORDERING

Type	Product No.	Frequency
MU 5-ZG/s	130001052	370 - 410 MHz
MU 5-ZG/l	130001054	406 - 440 MHz
MU 5-ZG/h	130001055	430 - 470 MHz
MU 5-ZGP4/s	130001058	370 - 410 MHz
MU 5-ZGP4/l	130001056	406 - 440 MHz
MU 5-ZGP4/h	130001057	430 - 470 MHz

SPECIFICATIONS

Electrical	
Model	MU 5-ZG/...
Frequency	450 MHz-band covered by three models
Antenna Type	Mobile whip antenna
Polarisation	Vertical
Impedance	50 Ω
Maximum Input Power	100 W
Gain (EIA RS-329-1)	0 dB
Mechanical	
Materials	Whip: Sturdy, flexible rubber with cast-in multicore steel wire radiating element Mount: Black-chromed brass Weather- and shockproof plastics Stainless steel
Installation Torque	7.5 +/- 1 Nm
Colour	Black
Height	175 mm / 6.89 in.
Weight	ZG-version: Approx. 130 g ZGP4-version: Approx. 270 g
Mounting	21 mm dia. hole

ADDITIONAL DATA

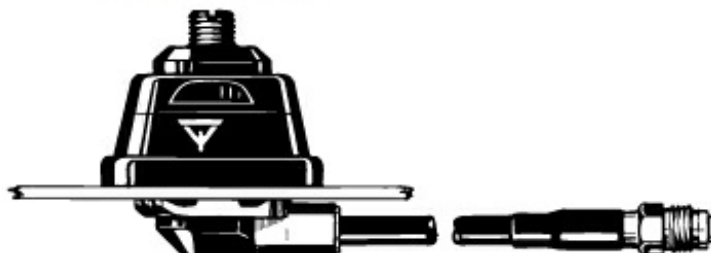
ZG-MOUNT**ZGP4-MOUNT**

INSTALLATION

This antenna should always be mounted on the car roof to ensure best omnidirectional coverage. The antenna is provided with our type ZG-mount for mounting from the outside in a 21 mm dia. hole.

The ZG-mount is provided with an M8 x 1 thread mount system. This construction meets the demand for a low-profile mobile mount with a slim appearance and with protection against theft of the antenna whip.

When cleaning the car in car-washing machines, the whip is easily removed using a spanner, size 12 mm. The whip is refitted again by screwing it onto the thread stud and tightening it with the spanner.

1. INSTALLATION DIMENSIONS

ZG-MOUNT

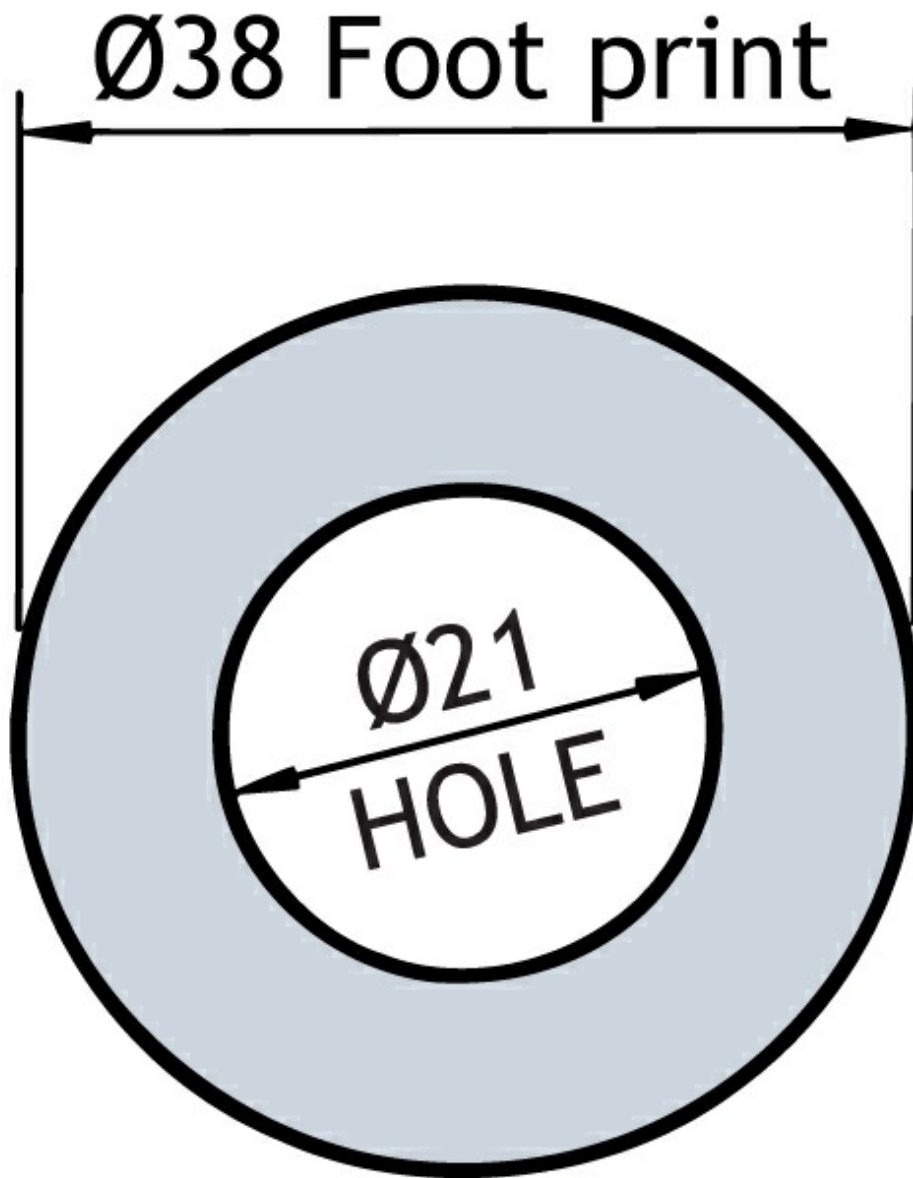

Build- in depth: 10.5 mm

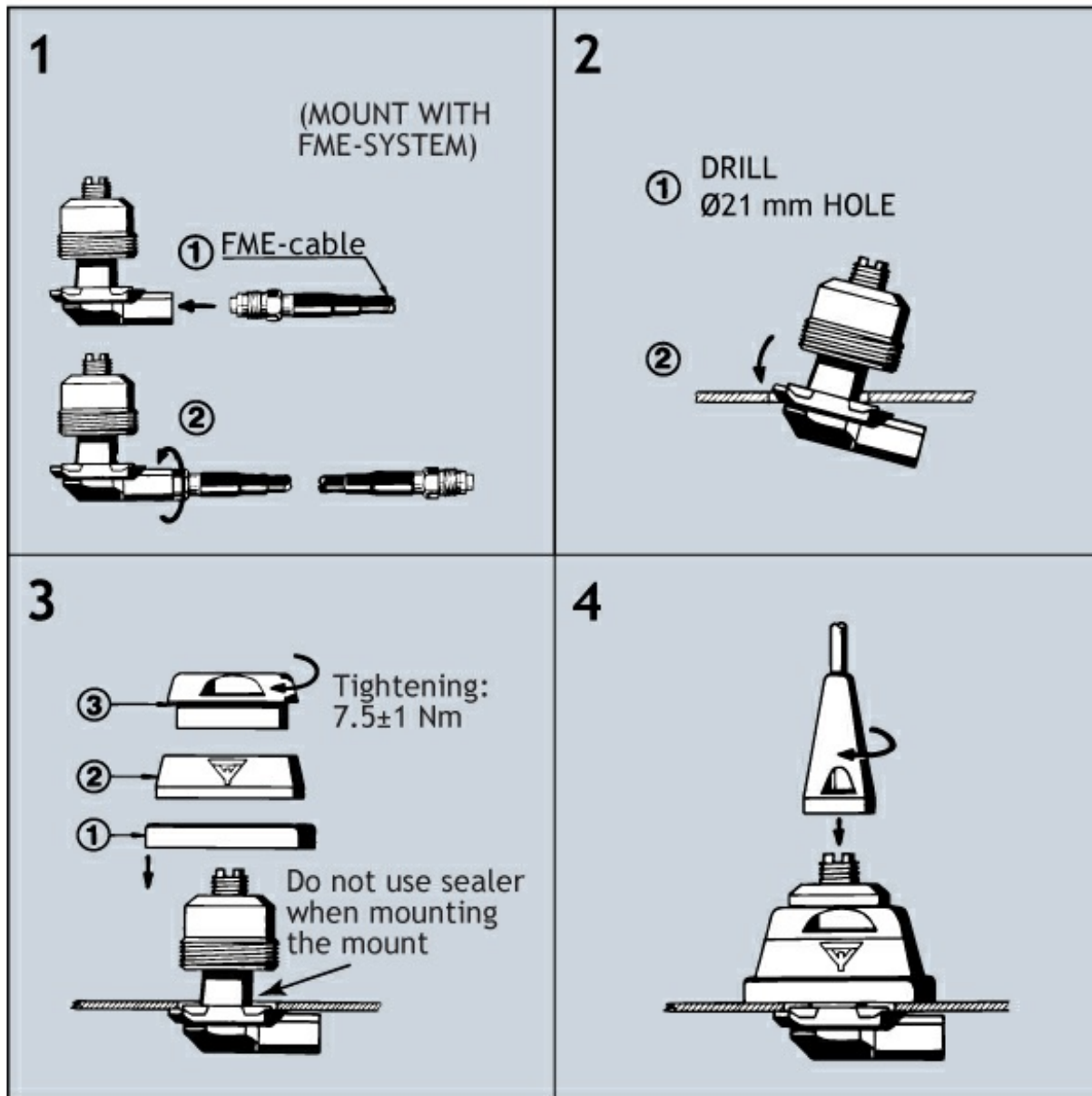

Do not use sealer on rubber gasket or other places.

3. TUNING/MODEL CONVERSION

The antenna is delivered factory-tuned and requires no further tuning.

To convert an MU 5-ZG/s model into an MU 5-ZG/l model, cut off 14 mm of the top end of the whip.

To convert an MU 5-ZG/l model into an MU 5-ZG/h model, cut off 8 mm of the top end of the whip.