

# 1/4 λ Mobile Antenna with Shock Spring for the 160 MHz Band

## DESCRIPTION

- Sturdy, general-purpose 1/4 λ antenna in professional quality.
- Available with glass fiber or stainless steel whip.
- Stainless steel ZG-mount with M8 x 1-thread whip-fastening system.
- Simple mounting exclusively with access from the outside.
- Choice between two connection principles:
  - ZG-mount: FME-connection (supplied without cable).
  - ZGP4-mount: Permanently attached 4 m cable terminated with FME-connector.

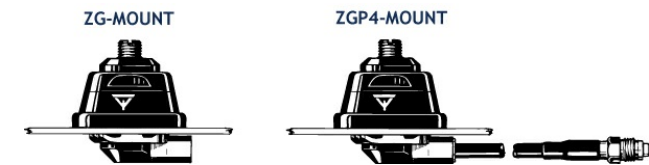

## ORDERING

Type	Product No.	Description	Frequency
MH 2-ZGR	130000738	Stainless Steel Whip	ZG-mount with FME-system
MH 2-ZGP4R	130000739	Stainless Steel Whip	ZGP4-mount with 4 m cable and FME-connector
MH 2-ZG	130000736	Glassfibre Whip	ZG-mount with FME-system
MH 2-ZGP4	130000737	Glassfibre Whip	ZGP4-mount with 4 m cable and FME-connector

## SPECIFICATIONS

Electrical	
Model	MH 2-ZG
Frequency	Tunable by cutting within: 144-175 MHz (Also applicable: 175-225 MHz)
Antenna Type	Mobile whip antenna
Polarisation	Vertical
Impedance	50 Ω
Maximum Input Power	150 W
Gain (EIA RS-329-1)	0 dB
Mechanical	
Materials	Whip: Conical glass fiber or black-chromed stainless steel. Black-chromed brass Spring: Black-chromed stainless steel Mount: Black-chromed brass Weather- and shockproof plastics Stainless steel
Installation Torque	7.5 +/- 1 Nm
Colour	Black
Height	550 mm / 21.65 in.
Weight	ZG-version: Approx. 200 g ZGP4-version: Approx. 350 g
Mounting	21 mm dia. hole

ADDITIONAL DATA

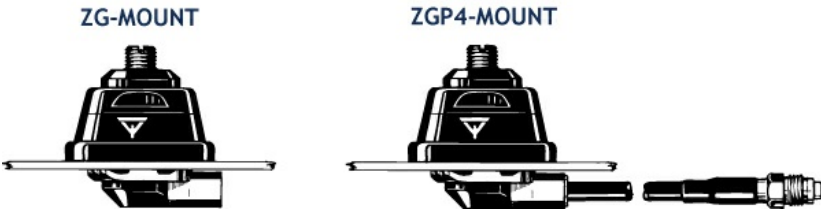

INSTALLATION

This antenna is provided with our type ZG-mount for mounting from the outside in a 21 mm dia. hole on horizontal surfaces as e.g. roof top or trunk lid.

The ZG-mount is provided with an M8 x 1 thread mount system. This construction meets the demand for a low-profile mobile mount with a slim appearance and with protection against theft of the antenna whip.

When cleaning the car in automatic washing machines, the whip is easily removed using a spanner, size 12 mm. The whip is refitted again by screwing it onto the M8 x 1 thread stud and tightening it with the spanner.

1. INSTALLATION DIMENSIONS

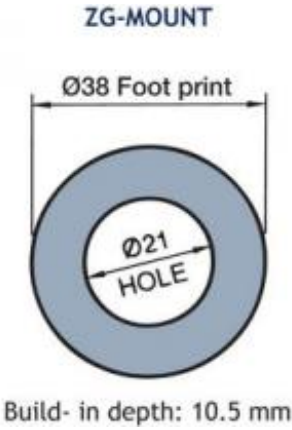

2. INSTALLATION STEPS

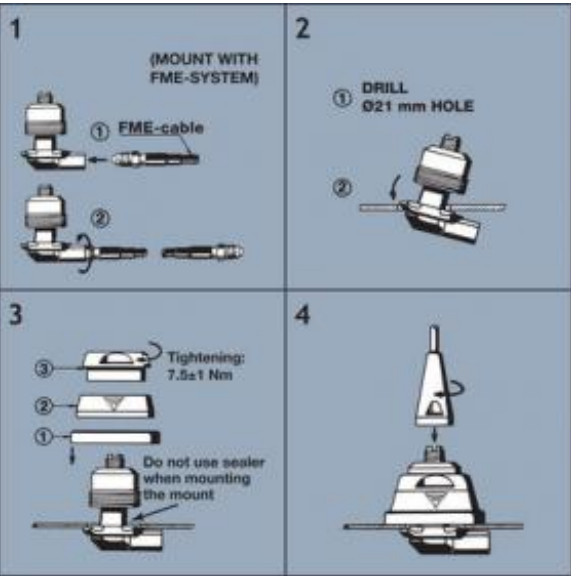

Do not use sealer on rubber gasket or other places.

3. TUNING

The antenna should always be tuned using an SWR-meter. The cutting diagrams below serve as a guide for this procedure.

GLASS FIBRE WHIP

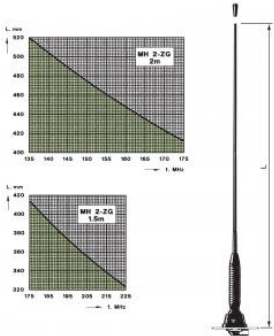

STAINLESS STEEL WHIP

