

SMP8100-9316

SMP jack crimp right angle
For RG174,RG188,RG316; 8GHz VSWR 1.2 50Ω

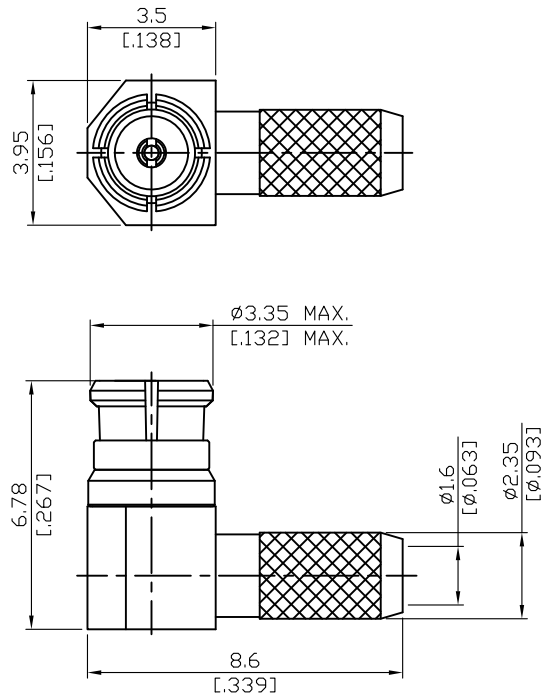

Parts	Material	Plating (Micro-inch)
Body	Beryllium Copper	Gold 4 Over Nickel-Phosphorus Alloy 80 Over Copper 20
Insulator	Teflon	
Contact Pin	Beryllium Copper	Gold 4 Over Nickel-Phosphorus Alloy 80 Over Copper 20
Retainer Ring	Beryllium Copper	Gold 4 Over Nickel-Phosphorus Alloy 80 Over Copper 20
Cover	Brass	Gold 4 Over Nickel-Phosphorus Alloy 80 Over Copper 20
Ferrule	Brass	Gold 4 Over Nickel-Phosphorus Alloy 80 Over Copper 20

Suitable Cables: RG174,RG188,RG316

This part number complies with RoHS.





Notice: JYEBAO reserves the right to make modifications deemed appropriate.

SMP		SMP8100-9316			
Interface					
MIL-STD-348B					
Electrical Data					
Impedance	50Ω				
Frequency range	DC to 8GHz				
VSWR	≤ 1.2 (DC to 8GHz)				
Insertion loss	≤ .06 x √f(GHz) dB				
Insulation resistance	≥ 5000 MΩ				
Contact resistance inner conductor	≤ 6mΩ				
Contact resistance outer conductor	≤ 2mΩ				
Dielectric withstanding voltage (at sea level)	500				
Working Voltage (at sea level)	335				
RF-Leakage	≥ 80dB (3GHz); ≥ 65dB (3~26.5GHz)				
Mechanical Data		Full Detent	Limited Detent	Smooth bore & catchers mit	
Engagement force	≤ 15	≤ 10	≤ 2		lbs
Disengagement force	≥ 5	≥ 2	≥ 0.5		lbs
Durability (mating)	≥ 100	≥ 500	≥ 1000		
Axial misalignment	+ 0.00 / -0.25 (+.000 / -.010)				
Radial misalignment	±0.25 (0.010)				
Environmental Data					
Temperature range	-65°C to +165°C				
Thermal shock	MIL-STD-202, Method 107, Condition B				
Moisture resistance	MIL-STD-202, Method 106				
Corrosion	MIL-STD-202, Method 101, Condition B				
RoHS	Compliant				
Tooling					
Crimping tool	CRT-1 or CRT-2				
Crimp insert	INSERT-A				

Notice: JYEBAO reserves the right to make modifications deemed appropriate.

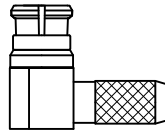
JYE BAO CO., LTD.

CABLE ASSEMBLY INSTRUCTION

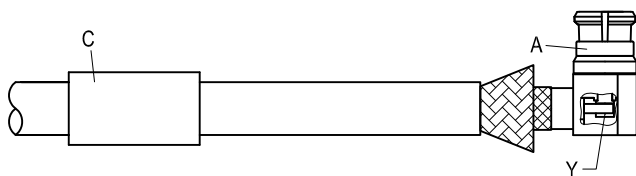
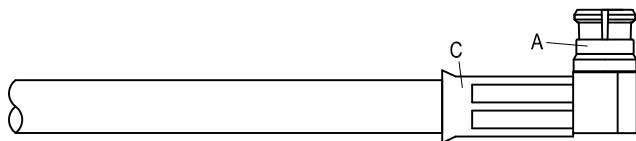
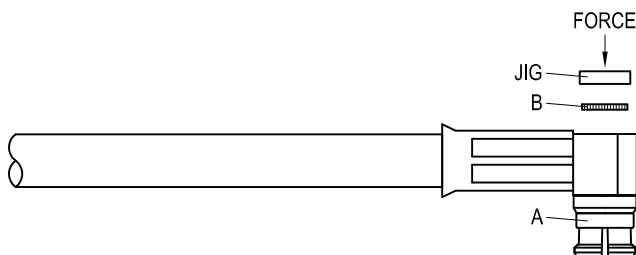
SMP8100-9316		DATE	2019/09/11	REV	A
A		B		C	
					
BODY		COVER		FERRULE	
DIAGRAM			ASSEMBLY INSTRUCTION		
			Step 1: STRIP AS SHOWN.		
			Step 2: SLIDE FERRULE "C" OVER CABLE. Step 3: WRAP THE BRAIDING UPWARDS. Step 4: SLIDE CENTER CONDUCTOR ON THE CONTACT PIN OF CONNECTOR "A" AND SOLDER IN "Y".		
			Step 5: SLIDE FERRULE "C" TOWARDS THE CONNECTOR "A" AND CRIMP. (USE 3.3mm/0.130inch HEX SECTION OF INSERT-A)		
			Step 6: PRESS ON THE TOP OF "B" WITH JIGS.		
This part number complies with RoHS. Notice: JYEBAO reserves the right to make modifications deemed appropriate.					
APPROVED		CHECKED		DRAWING	
				Albert	

SMP8100-9316

S11

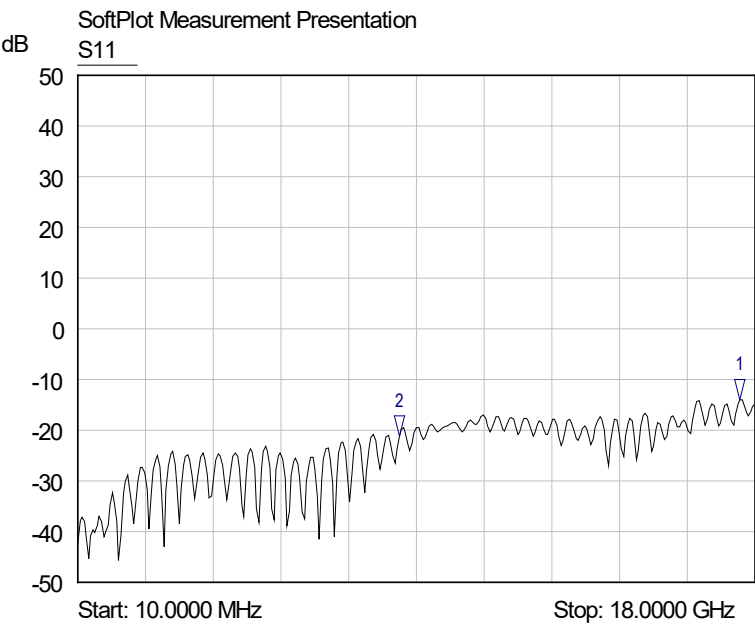

- 1 S11
▽ 17.5989 GHz
-14.03 dB
- 2 S11
▽ 8.5467 GHz
-21.23 dB