

SMA3300A-9085

SMA Plug Solder Right Angle

50Ω

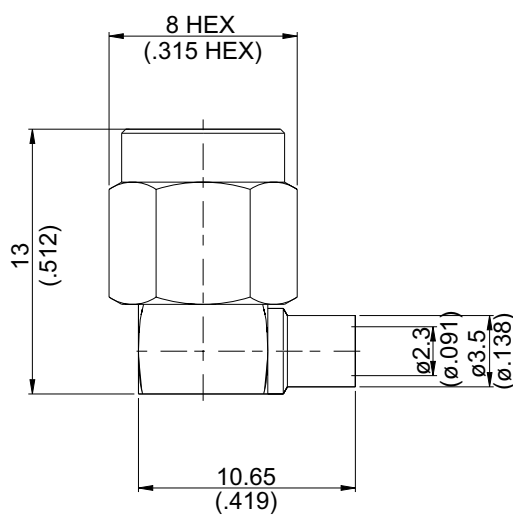

Parts	Material	Plating (Micro-inch)
Cover	Brass	Gold 5 Over Nickel 50 Over Copper 50
Contact Pin	Brass	Gold 20 Over Nickel 50 Over Copper 50
Renbrock Ring	Beryllium Copper	Tin-Zinc-Copper-Alloy 100 Over Copper 50
Gasket	Silicon	
Insulator	Teflon	
Body	Brass	Gold 5 Over Nickel 50 Over Copper 50
Coupling Nut	Brass	Gold 5 Over Nickel 50 Over Copper 50

Weight: 3.53 g

Suitable Cables: Semi-rigid.085

This part number complies with RoHS.

Notice: JYEBAO reserves the right to make modifications deemed appropriate.

CABLE ASSEMBLY INSTRUCTION

SMA3300A-9085

JYE BAO CO., LTD.

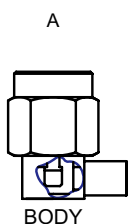

DIAGRAM

ASSEMBLY INSTRUCTION

Step 1: STRIP AS SHOWN .

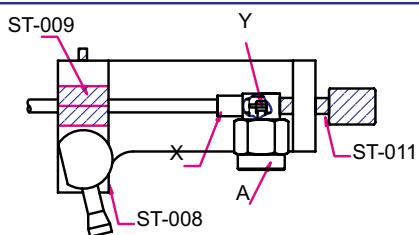
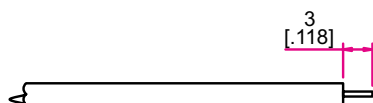

Step 2: INSERT PREPARED CABLE INTO CONNECTOR BODY " A " AND USE SOLDERING FIXTURE " ST-008 ", INSERT TOOL " ST-009 " AND LOCATOR TOOL " ST-011 " TO FIX THE CONNECTOR. SOLDER IN " Y " AND SOLDER IN " X " .

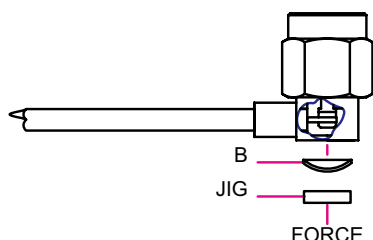

Step 3: PRESS ON THE TOP OF " B " WITH JIGS .

This part number complies with RoHS.

Notice: JYEBAO reserves the right to make modifications deemed appropriate.