

SMA3100-L240/PEEK

SMA Plug Crimp, Radiation Resistant,
For JBY240, LMR240; 6GHz VSWR 1.2

50Ω

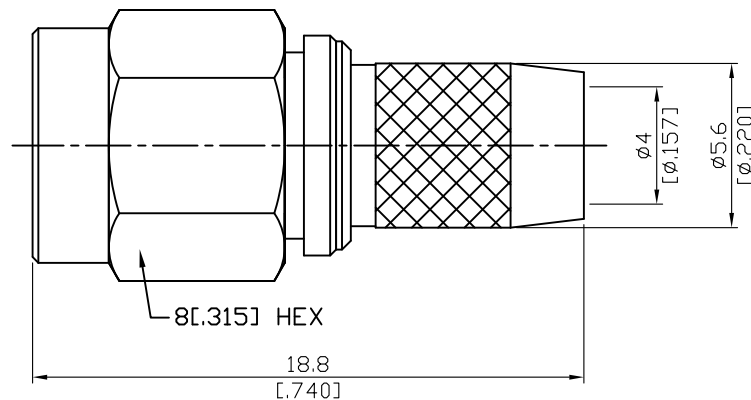

Note: Radiation Resistant

Parts	Material	Plating (Micro-inch)
Coupling Nut	Brass	Gold 4 Over Nickel-Phosphorus Alloy 80 Over Copper 20
Body	Brass	Gold 4 Over Nickel-Phosphorus Alloy 80 Over Copper 20
Insulator	PEEK	
Gasket	Silicone	
Retainer Ring	Beryllium Copper	Tin-Zinc-Copper-Alloy 100 Over Copper 50
Contact Pin	Brass	Gold 4 Over Nickel-Phosphorus Alloy 80 Over Copper 20
Ferrule	Copper	Gold 4 Over Nickel-Phosphorus Alloy 80 Over Copper 20

Suitable Cables: LMR240, JBY240

This part number complies with RoHS.



Notice: JYEBAO reserves the right to make modifications deemed appropriate.

SMA	SMA3100-L240/PEEK
Interface MIL-STD-348B Mechanically compatible with 2.92 & 3.5	
Electrical Data Impedance 50Ω Frequency range DC to 6GHz VSWR ≤ 1.2 (DC to 6GHz) Insertion loss $\leq 0.04 \times \sqrt{f(\text{GHz})}$ dB Insulation resistance $\geq 5000\text{M}\Omega$ Contact resistance inner conductor $\leq 3\text{m}\Omega$ Contact resistance outer conductor $\leq 2\text{m}\Omega$ Dielectric withstanding voltage (at sea level) 1000 V rms Working voltage (at sea level) 335 V rms	
Mechanical Data Recommended coupling nut torque 4 inch lbs Coupling proof torque 5.3 inch lbs Coupling nut retention force ≥ 60.7 lbs Contact Captivation-axial ≥ 6.1 lbs Durability (mating) ≥ 100	
Environmental Data Temperature range -40°C to +165°C Thermal shock MIL-STD-202, Method 107, Condition B Moisture resistance MIL-STD-202, Method 106 Corrosion MIL-STD-202, Method 101, Condition B RoHS Compliant	
Tooling Crimping tool CRT-1 or CRT-2 Crimp insert INSERT-E Soldering gauge ST-0.1	

Notice: JYEBAO reserves the right to make modifications deemed appropriate.

JYE BAO CO., LTD.

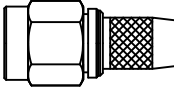
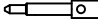
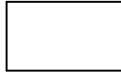
CABLE ASSEMBLY INSTRUCTION

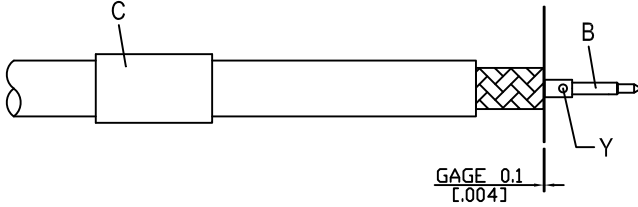
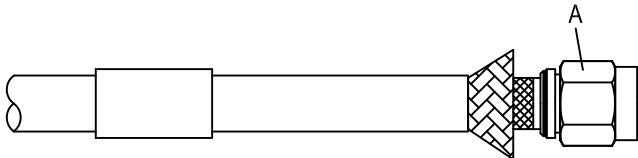
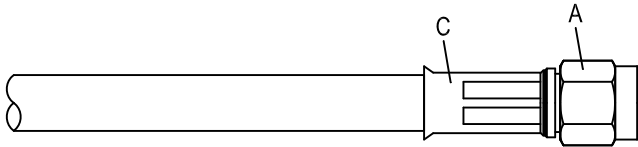
SMA3100-L240/PEEK		DATE	2019/05/14	REV	—
A		B		C	
					
BODY		CONTACT PIN		FERRULE	
DIAGRAM			ASSEMBLY INSTRUCTION		
			Step 1: STRIP AS SHOWN.		
			Step 2: SLIDE FERRULE "C" OVER CABLE. Step 7: PUT 0.1 MM GAGE IN PLACE, INSERT CABLE'S CENTER CONDUCTOR INTO CENTER PIN "B" AND SOLDER IN "Y".		
			Step 4: LOOSEN BRAIDING AND SLIDE CONNECTOR "A" IN PLACE.		
			Step 5: SLIDE FERRULE "C" TOWARDS THE CONNECTOR "A" AND CRIMP. (USE 6.5mm/0.256inch HEX SECTION OF INSERT-E)		
This part number complies with RoHS. Notice: JYEBAO reserves the right to make modifications deemed appropriate.					
APPROVED		CHECKED		DRAWING	
				Albert	

SMA3100-L240-PEEK

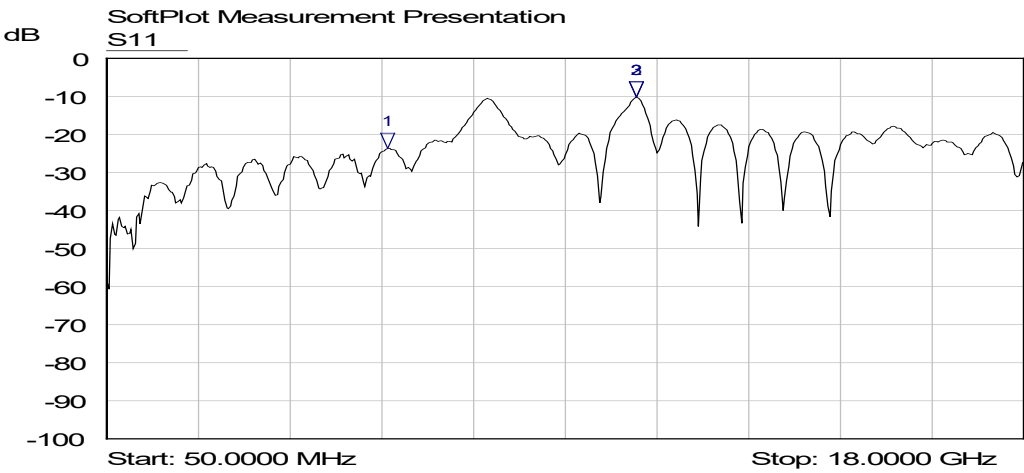

Mkr	Trace	X-Axis	Value	Notes
1 ▾	S11	5.5478 GHz	-23.62 dB	
2 ▾	S11	10.4225 GHz	-10.21 dB	
3 ▾	S11	10.4225 GHz	-10.21 dB	