

N3175B-L400

N Plug Crimp For JBY400-75; LMR400-75

75Ω

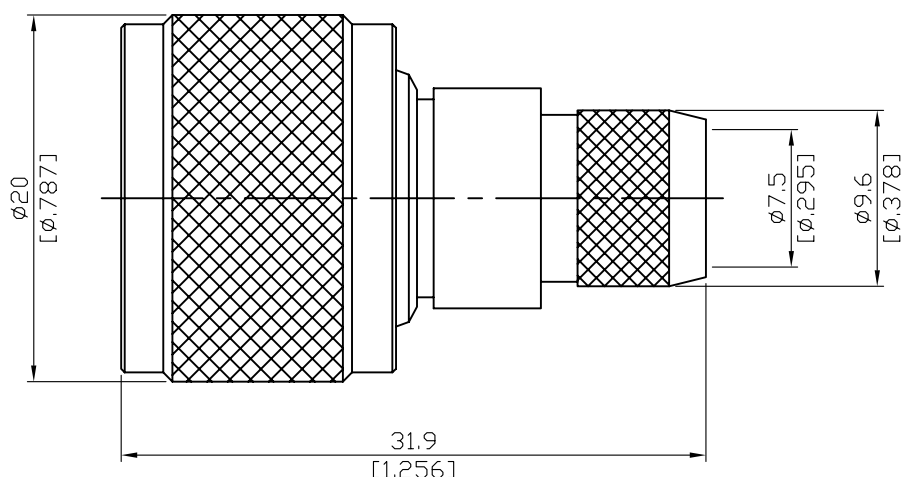

Parts	Material	Plating (Micro-inch)
Ferrule	Copper	Tin-Zinc-Copper-Alloy 100 Over Copper 50
Gasket	Silicone	
Contact Pin	Brass	Gold 4 Over Nickel-Phosphorus Alloy 80 Over Copper 20
Insulator	Teflon	
Body	Brass	Tin-Zinc-Copper-Alloy 100 Over Copper 50
Coupling Nut	Brass	Tin-Zinc-Copper-Alloy 100 Over Copper 50



Suitable Cables: JBY400-75, LMR400-75

This part number complies with RoHS.

Notice: JYEBAO reserves the right to make modifications deemed appropriate.

JYE BAO CO., LTD.

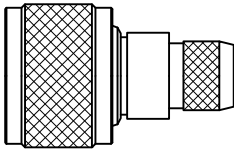
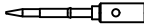
CABLE ASSEMBLY INSTRUCTION

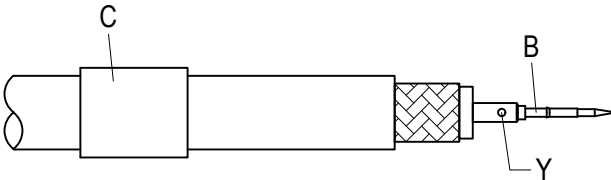
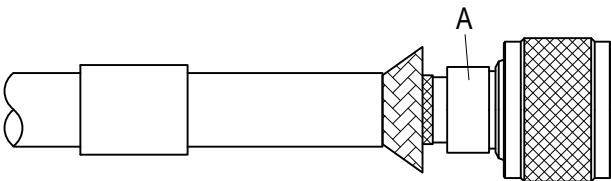
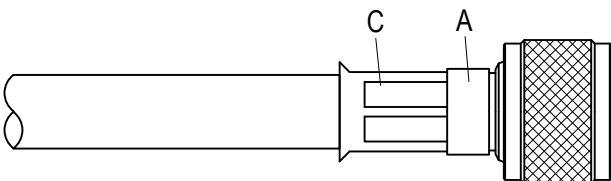
N3175B-L400		DATE	2019/01/18	REV	—
A		B		C	
					
BODY		CONTACT PIN		FERRULE	
DIAGRAM			ASSEMBLY INSTRUCTION		
			Step 1: STRIP AS SHOWN.		
			Step 2: SLIDE FERRULE " C " OVER CABLE. Step 3: PUT PIN " B " ON CENTER CONDUCTOR AND SOLDER IN " Y ".		
			Step 4: LOOSEN BRAIDING AND SLIDE CONNECTOR " A " IN PLACE.		
			Step 5: SLIDE FERRULE " C " TOWARDS THE CONNECTOR " A " AND CRIMP. (USE 10.7mm/0.421inch HEX SECTION OF INSERT-C)		
This part number complies with RoHS. Notice: JYEBAO reserves the right to make modifications deemed appropriate.					
APPROVED		CHECKED		DRAWING	
				Albert	