

AD-A8A8-P4	SMA Jack to SMA Jack 4 Hole Flange 18GHz VSWR 1.2	50Ω
------------	--	-----

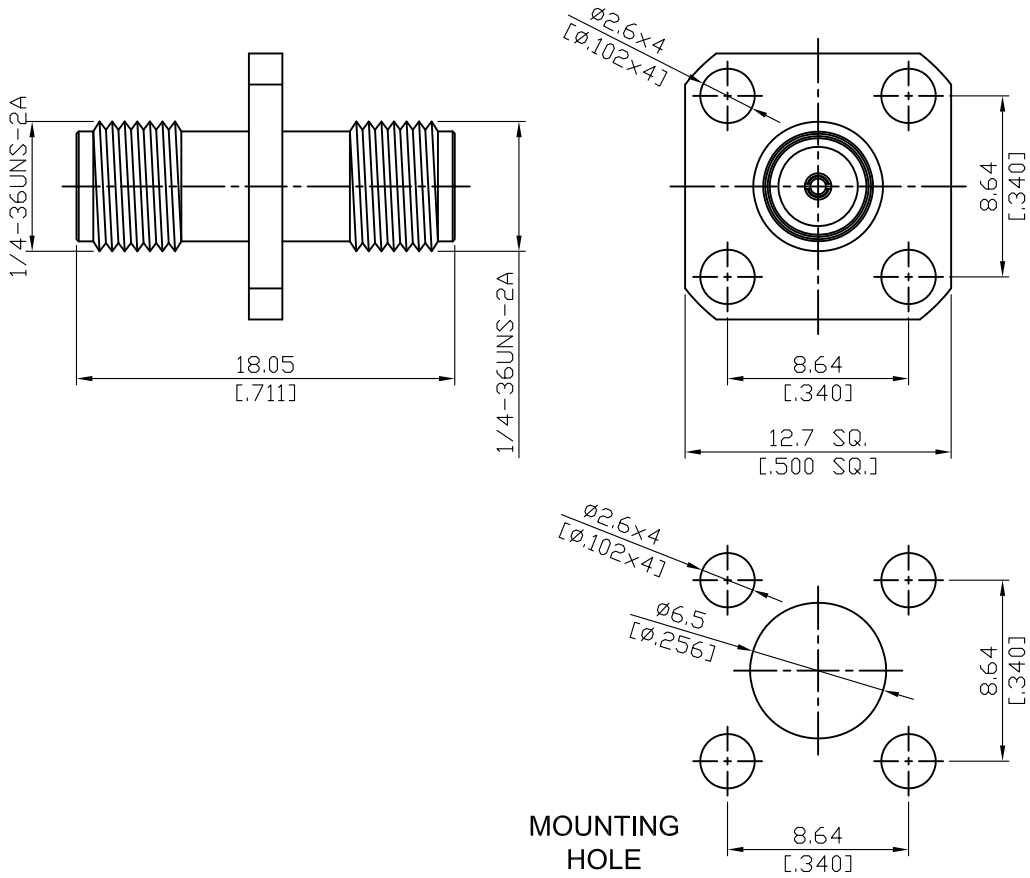

Parts	Material	Plating ( Micro-inch )
Body	Brass	Gold 4 Over Nickel-Phosphorus Alloy 80 Over Copper 20
Insulator	Teflon	
Contact Pin	Beryllium Copper	Gold 4 Over Nickel-Phosphorus Alloy 80 Over Copper 20

Weight: 3.53g	
---------------	--

This part number complies with RoHS.  
 Notice: JYEBAO reserves the right to make modifications deemed appropriate.

AD-A8A8-P4	SMA Jack to SMA Jack 4 Hole Flange 18GHz VSWR 1.2																
<table border="0"> <tr> <td colspan="2" data-bbox="129 342 531 392"><b>Interface</b></td> </tr> <tr> <td data-bbox="129 405 774 436">Standard</td> <td data-bbox="783 405 997 436">MIL-STD-348B</td> </tr> <tr> <td data-bbox="129 450 774 481">Mechanically compatible with</td> <td data-bbox="783 450 933 481">2.92 &amp; 3.5</td> </tr> </table>		<b>Interface</b>		Standard	MIL-STD-348B	Mechanically compatible with	2.92 & 3.5										
<b>Interface</b>																	
Standard	MIL-STD-348B																
Mechanically compatible with	2.92 & 3.5																
<table border="0"> <tr> <td colspan="2" data-bbox="129 607 531 656"><b>Electrical Data</b></td> </tr> <tr> <td data-bbox="129 663 774 694">Impedance</td> <td data-bbox="783 663 853 694">50Ω</td> </tr> <tr> <td data-bbox="129 707 774 739">Frequency Range</td> <td data-bbox="783 707 997 739">DC To 18GHz</td> </tr> <tr> <td data-bbox="129 752 774 784">VSWR</td> <td data-bbox="783 752 1109 784">≤ 1.2 (DC To 18GHz)</td> </tr> <tr> <td data-bbox="129 797 774 828">Insertion Loss</td> <td data-bbox="783 797 1109 828">≤ 0.04 x √f(GHz) dB</td> </tr> <tr> <td data-bbox="129 842 774 873">Insulation Resistance</td> <td data-bbox="783 842 949 873">≥ 5000MΩ</td> </tr> <tr> <td data-bbox="129 887 774 918">Dielectric Withstanding Voltage (at sea level)</td> <td data-bbox="783 887 965 918">1500 V rms</td> </tr> <tr> <td data-bbox="129 931 774 963">Working Voltage (at sea level)</td> <td data-bbox="783 931 949 963">500 V rms</td> </tr> </table>		<b>Electrical Data</b>		Impedance	50Ω	Frequency Range	DC To 18GHz	VSWR	≤ 1.2 (DC To 18GHz)	Insertion Loss	≤ 0.04 x √f(GHz) dB	Insulation Resistance	≥ 5000MΩ	Dielectric Withstanding Voltage (at sea level)	1500 V rms	Working Voltage (at sea level)	500 V rms
<b>Electrical Data</b>																	
Impedance	50Ω																
Frequency Range	DC To 18GHz																
VSWR	≤ 1.2 (DC To 18GHz)																
Insertion Loss	≤ 0.04 x √f(GHz) dB																
Insulation Resistance	≥ 5000MΩ																
Dielectric Withstanding Voltage (at sea level)	1500 V rms																
Working Voltage (at sea level)	500 V rms																
<table border="0"> <tr> <td colspan="2" data-bbox="129 1104 531 1153"><b>Mechanical Data</b></td> </tr> <tr> <td data-bbox="129 1160 774 1191">Recommended Coupling Nut Torque</td> <td data-bbox="783 1160 917 1191">4 in-lbs</td> </tr> <tr> <td data-bbox="129 1205 774 1236">Coupling Proof Torque</td> <td data-bbox="783 1205 949 1236">5.3 in-lbs</td> </tr> <tr> <td data-bbox="129 1249 774 1281">Contact Captivation-axial</td> <td data-bbox="783 1249 949 1281">≥ 6.1 lbs</td> </tr> <tr> <td data-bbox="129 1294 774 1326">Durability (mating)</td> <td data-bbox="783 1294 901 1326">≥ 100</td> </tr> </table>		<b>Mechanical Data</b>		Recommended Coupling Nut Torque	4 in-lbs	Coupling Proof Torque	5.3 in-lbs	Contact Captivation-axial	≥ 6.1 lbs	Durability (mating)	≥ 100						
<b>Mechanical Data</b>																	
Recommended Coupling Nut Torque	4 in-lbs																
Coupling Proof Torque	5.3 in-lbs																
Contact Captivation-axial	≥ 6.1 lbs																
Durability (mating)	≥ 100																
<table border="0"> <tr> <td colspan="2" data-bbox="129 1507 531 1556"><b>Environmental Data</b></td> </tr> <tr> <td data-bbox="129 1563 774 1594">Temperature Range</td> <td data-bbox="783 1563 1029 1594">-65°C to +165°C</td> </tr> <tr> <td data-bbox="129 1608 774 1639">Thermal Shock</td> <td data-bbox="783 1608 1364 1639">MIL-STD-202, Method 107, Condition B</td> </tr> <tr> <td data-bbox="129 1653 774 1684">Moisture Resistance</td> <td data-bbox="783 1653 1189 1684">MIL-STD-202, Method 206</td> </tr> <tr> <td data-bbox="129 1697 774 1729">Corrosion</td> <td data-bbox="783 1697 1364 1729">MIL-STD-202, Method 101, Condition B</td> </tr> <tr> <td data-bbox="129 1742 774 1774">RoHS</td> <td data-bbox="783 1742 949 1774">Compliant</td> </tr> </table>		<b>Environmental Data</b>		Temperature Range	-65°C to +165°C	Thermal Shock	MIL-STD-202, Method 107, Condition B	Moisture Resistance	MIL-STD-202, Method 206	Corrosion	MIL-STD-202, Method 101, Condition B	RoHS	Compliant				
<b>Environmental Data</b>																	
Temperature Range	-65°C to +165°C																
Thermal Shock	MIL-STD-202, Method 107, Condition B																
Moisture Resistance	MIL-STD-202, Method 206																
Corrosion	MIL-STD-202, Method 101, Condition B																
RoHS	Compliant																

Notice: JYEBAO reserves the right to make modifications deemed appropriate.

# AD-A8A8-P4

